

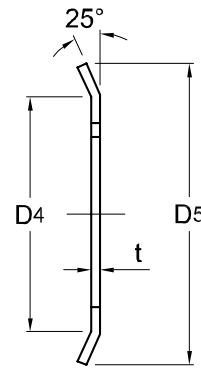

Lock Washers
AW
FLAT TAB

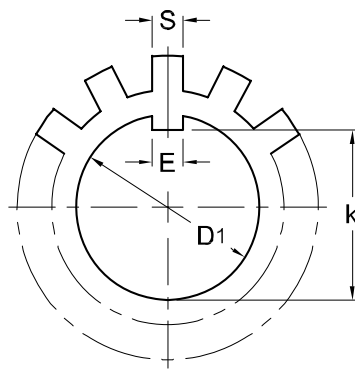

| Lock Washer ¹⁾ Part No. | D ₁ mm | k mm | E mm | t mm | S mm | D ₄ mm | D ₅ mm | Number of tongues | Lock nut No. | Weight per 100 pieces (kgs) |
|---------------------------------------|----------------------|---------|---------|---------|---------|----------------------|----------------------|----------------------|-----------------|-----------------------------------|
| AW 00 | 10 | 8.5 | 3 | 1 | 3 | 13.5 | 21 | 9 | AN 00 | 0.131 |
| AW 01 | 12 | 10.5 | 3 | 1 | 3 | 17 | 25 | 9 | AN 01 | 0.192 |
| AW 02 | 15 | 13.5 | 4 | 1 | 4 | 21 | 28 | 13 | AN 02 | 0.253 |
| AW 03 | 17 | 15.5 | 4 | 1 | 4 | 24 | 32 | 13 | AN 03 | 0.313 |
| AW 04 | 20 | 18.5 | 4 | 1 | 4 | 26 | 36 | 13 | AN 04 | 0.350 |
| AW 05 | 25 | 23 | 5 | 1.2 | 5 | 32 | 42 | 13 | AN 05 | 0.640 |
| AW 06 | 30 | 27.5 | 5 | 1.2 | 5 | 38 | 49 | 13 | AN 06 | 0.780 |
| AW 07 | 35 | 32.5 | 6 | 1.2 | 5 | 44 | 57 | 15 | AN 07 | 1.040 |
| AW 08 | 40 | 37.5 | 6 | 1.2 | 6 | 50 | 62 | 15 | AN 08 | 1.230 |
| AW 09 | 45 | 42.5 | 6 | 1.2 | 6 | 56 | 69 | 17 | AN 09 | 1.520 |
| AW 10 | 50 | 47.5 | 6 | 1.2 | 6 | 61 | 74 | 17 | AN 10 | 1.600 |
| AW 11 | 55 | 52.5 | 8 | 1.5 | 7 | 67 | 81 | 17 | AN 11 | 1.960 |
| AW 12 | 60 | 57.5 | 8 | 1.5 | 7 | 73 | 86 | 17 | AN 12 | 2.530 |
| AW 13 | 65 | 62.5 | 8 | 1.5 | 7 | 79 | 92 | 19 | AN 13 | 2.900 |
| AW 14 | 70 | 66.5 | 8 | 1.5 | 8 | 85 | 98 | 19 | AN 14 | 3.340 |
| AW 15 | 75 | 71.5 | 8 | 1.5 | 8 | 90 | 104 | 19 | AN 15 | 3.560 |
| AW 16 | 80 | 76.5 | 10 | 1.8 | 8 | 95 | 112 | 19 | AN 16 | 4.640 |
| AW 17 | 85 | 81.5 | 10 | 1.8 | 8 | 102 | 119 | 19 | AN 17 | 5.240 |
| AW 18 | 90 | 86.5 | 10 | 1.8 | 10 | 108 | 126 | 19 | AN 18 | 6.230 |
| AW 19 | 95 | 91.5 | 10 | 1.8 | 10 | 113 | 133 | 19 | AN 19 | 6.700 |
| AW 20 | 100 | 96.5 | 12 | 1.8 | 10 | 120 | 142 | 19 | AN 20 | 7.650 |
| AW 21 | 105 | 100.5 | 12 | 1.8 | 12 | 126 | 145 | 19 | AN 21 | 8.260 |
| AW 22 | 110 | 105.5 | 12 | 1.8 | 12 | 133 | 154 | 19 | AN 22 | 9.400 |
| AW 23 | 115 | 110.5 | 12 | 2 | 12 | 137 | 159 | 19 | AN 23 | 10.800 |
| AW 24 | 120 | 115 | 14 | 2 | 12 | 138 | 164 | 19 | AN 24 | 10.500 |
| AW 25 | 125 | 120 | 14 | 2 | 12 | 148 | 170 | 19 | AN 25 | 11.800 |
| AW 26 | 130 | 125 | 14 | 2 | 12 | 149 | 175 | 19 | AN 26 | 11.300 |
| AW 27 | 135 | 130 | 14 | 2 | 14 | 160 | 185 | 19 | AN 27 | 14.400 |
| AW 28 | 140 | 135 | 16 | 2 | 14 | 160 | 192 | 19 | AN 28 | 14.200 |
| AW 29 | 145 | 140 | 16 | 2 | 14 | 171 | 202 | 19 | AN 29 | 16.800 |
| AW 30 | 150 | 145 | 16 | 2 | 14 | 171 | 205 | 19 | AN 30 | 15.500 |
| AW 31 | 155 | 147.5 | 16 | 2.5 | 16 | 182 | 212 | 19 | AN 31 | 20.900 |
| AW 32 | 160 | 154 | 18 | 2.5 | 16 | 182 | 217 | 19 | AN 32 | 22.200 |
| AW 33 | 165 | 157.5 | 18 | 2.5 | 16 | 193 | 222 | 19 | AN 33 | 24.100 |
| AW 34 | 170 | 164 | 18 | 2.5 | 16 | 193 | 232 | 19 | AN 34 | 24.700 |
| AW 36 | 180 | 174 | 20 | 2.5 | 18 | 203 | 242 | 19 | AN 36 | 26.800 |
| AW 38 | 190 | 184 | 20 | 2.5 | 18 | 214 | 252 | 19 | AN 38 | 27.800 |
| AW 40 | 200 | 194 | 20 | 2.5 | 18 | 226 | 262 | 19 | AN 40 | 29.300 |
| AW 44 | 220 | 213 | 24 | 3 | 20 | 250 | 292 | 19 | AN 44 | 48.300 |
| AW 48 | 240 | 233 | 24 | 3 | 20 | 270 | 312 | 19 | AN 48 | 50.200 |
| AW 52 | 260 | 253 | 28 | 3 | 24 | 300 | 342 | 23 | AN 52 | 72.900 |
| AW 56 | 280 | 273 | 28 | 3 | 24 | 320 | 362 | 23 | AN 56 | 75.900 |

NOTE:

1) The specifications of AW can be applied for MB.

AW的尺寸規格適用於MB。

Chin Sung Enterprise Co., Ltd.